

21-180S

Original Instructions

GENERAL WARNINGS & DISPOSAL



To reduce the risk of injury, the user must read the instruction manual.



This symbol is used throughout this manual to warn the user about potential risks. Please read & understand these sections before using the device.



Personal Protective Equipment (P.P.E.), such as ear defenders, eye protection, safety gloves and a dust mask, must be worn during the operation of the device.



The device must not be exposed to rain or immersed in water.



Do not allow any part of the device to come into contact with flames, or to catch fire.



Do not expose battery pack or tool to fire or excessive temperatures.



Do not dispose of batteries in household waste. Return exhausted batteries to a local collection or recycling point.



This product has been marked with a symbol relating to removing electric and electronic waste. The product should not be discarded with household waste but must be returned to a collection system which conforms to the EU Directive 2012/19/EU or the UK Waste Electrical and Electronic Equipment Regulations 2013. It will then be recycled or dismantled in order to reduce the impact on the environment. Electric and electronic equipment can be hazardous for the environment and for human health since they contain hazardous substances.

The month and year of manufacture can be found within the product serial number e.g. MMYYPXXAXXXXX. Where production month (MM) and production year (YY) are included.
JCB-180S Designation of the tool (18 - 18Vdc, OS - Orbital Sander)



Contents

GENERAL POWER TOOL SAFETY WARNINGS	4
1. Work area safety	4
2. Electrical safety	4
3. Personal safety	4
4. Power tool use and care	5
5. Battery tool use and care	5
6. Service	6
SAFETY WARNINGS COMMON FOR SANDING	7
Additional Safety Rules For Orbital Sanders	7
Kickback and Related Warnings	8
CHARGER SAFETY	9
COMPONENT LIST	10
TOOL TECHNICAL DATA	11
BATTERY TECHNICAL DATA	11
CHARGER TECHNICAL DATA	11
NOISE INFORMATION	12
VIBRATION INFORMATION	13
OPERATING INSTRUCTIONS	14
Intended Use	14
ON/OFF SWITCH	14
Changing a Sanding Sheet	14
Dust Suction and Dust Extractor Pipe	14
Sanding Surfaces and Grade of Sandpaper	15
BATTERY AND CHARGER OPERATING INSTRUCTIONS	16
Overload Protection	17
MAINTENANCE	17
Transport and Storage	17
WARRANTY STATEMENT	20
Terms and Conditions	21
EU/UK DECLARATION OF CONFORMITY	22



GENERAL POWER TOOL SAFETY WARNINGS

WARNING!

Read all safety warnings, instructions and specifications provided with this power tool. Failure to follow all instructions listed below may result in electric shock, fire and/or serious injury. **Save all warnings and instructions for future reference.**

The term “power tool” in the warnings refers to your mains operated (corded) power tool or battery operated (cordless) power tool.

1. Work area safety

- **Keep work area clean and well lit.**
Cluttered or dark areas invite accidents.
- **Do not operate power tools in explosive atmospheres, such as in the presence of flammable liquids, gases or dust.** Power tools create sparks which may ignite the dust or fumes.
- **Keep children and bystanders away while operating a power tool.** Distractions can cause you to lose control.

2. Electrical safety

- **Power tool plugs must match the outlet. Never modify the plug in any way. Do not use any adapter plugs with earthed (grounded) power tools.** Unmodified plugs and matching outlets will reduce risk of electric shock.
- **Avoid body contact with earthed or grounded surfaces, such as pipes, radiators, ranges and refrigerators.** There is an increased risk of electric shock if your body is earthed or grounded.
- **Do not expose power tools to rain or wet conditions.** Water entering a power tool will increase the risk of electric shock.

- **Do not abuse the cord. Never use the cord for carrying, pulling or unplugging the power tool. Keep the cord away from heat, oil, sharp edges or moving parts.**
Damaged or entangled cords increase the risk of electric shock.
- **When operating a power tool outdoors, use an extension cord suitable for outdoor use.** Use of a cord suitable for outdoor use reduces the risk of electric shock.
- **If operating a power tool in a damp location is unavoidable, use a residual current device (RCD) protected supply.**
Use of an RCD reduces the risk of electric shock.

3. Personal safety

- **Stay alert, watch what you are doing and use common sense when operating a power tool. Do not use a power tool while you are tired or under the influence of drugs, alcohol or medication.** A moment of inattention while operating power tools may result in serious personal injury.
- **Use personal protective equipment. Always wear eye protection.** Protective equipment such as a dust mask, non-skid safety shoes, hard hat or hearing protection used for appropriate conditions will reduce personal injuries.
- **Prevent unintentional starting. Ensure the switch is in the off position before connecting to power source and/or battery pack, picking up or carrying the tool.** Carrying power tools with your finger on the switch or energising power tools that have the switch on invites accidents.

- **Remove any adjusting key or wrench before turning the power tool on.** A wrench or a key left attached to a rotating part of the power tool may result in personal injury.
- **Do not overreach. Keep proper footing and balance at all times.** This enables better control of the power tool in unexpected situations.
- **Dress properly. Do not wear loose clothing or jewellery. Keep your hair and clothing away from moving parts.** Loose clothes, jewellery or long hair can be caught in moving parts.
- **If devices are provided for the connection of dust extraction and collection facilities, ensure these are connected and properly used.** Use of dust collection can reduce dust-related hazards.
- **Do not let familiarity gained from frequent use of tools allow you to become complacent and ignore tool safety principles.** A careless action can cause severe injury within a fraction of a second.

4. Power tool use and care

- **Do not force the power tool. Use the correct power tool for your application.** The correct power tool will do the job better and safer at the rate for which it was designed.
- **Do not use the power tool if the switch does not turn it on and off.** Any power tool that cannot be controlled with the switch is dangerous and must be repaired.
- **Disconnect the plug from the power source and/or remove the battery pack, if detachable, from the power tool before making any adjustments, changing accessories, or storing power tools.** Such preventive safety measures reduce the risk of starting the power tool accidentally.

- **Store idle power tools out of the reach of children and do not allow persons unfamiliar with the power tool or these instructions to operate the power tool.** Power tools are dangerous in the hands of untrained users.
- **Maintain power tools and accessories. Check for misalignment or binding of moving parts, breakage of parts and any other condition that may affect the power tool's operation. If damaged, have the power tool repaired before use.** Many accidents are caused by poorly maintained power tools.
- **Keep cutting tools sharp and clean.** Properly maintained cutting tools with sharp cutting edges are less likely to bind and are easier to control.
- **Use the power tool, accessories and tool bits etc. in accordance with these instructions, taking into account the working conditions and the work to be performed.** Use of the power tool for operations different from those intended could result in a hazardous situation.

- **Keep handles and grasping surfaces dry, clean and free from oil and grease.** Slippery handles and grasping surfaces do not allow for safe handling and control of the tool in unexpected situations.

5. Battery tool use and care

- **Recharge only with the charger specified by the manufacturer.** A charger that is suitable for one type of battery pack may create a risk of fire when used with another battery pack.
- **Use power tools only with specifically designated battery packs.** Use of any other battery packs may create a risk of injury and fire.



- › **When the battery pack is not in use, keep it away from other metal objects, like paper clips, coins, keys, nails, screws or other small metal objects that can make a connection from one terminal to another.**

Shorting the battery terminals together may cause burns or a fire.

- › **Under abusive conditions, liquid may be ejected from the battery; avoid contact. If contact accidentally occurs, flush with water. If liquid contacts eyes, additionally seek medical help.**

Liquid ejected from the battery may cause irritation or burns.

- › **Do not use a battery pack or tool that is damaged or modified.**

Damaged or modified batteries may exhibit unpredictable behaviour resulting in fire, an explosion or risk of injury.

- › **Do not expose a battery pack or tool to fire or excessive temperature.**

Exposure to fire or temperature above 130 °C may cause explosion.

- › **Follow all charging instructions and do not charge the battery pack or tool outside the temperature range specified in the instructions.**

Charging improperly or at temperatures outside the specified range may damage the battery and increase the risk of fire.

6. Service

- › **Have your power tool serviced by a qualified repair person using only identical replacement parts.**

This will ensure that the safety of the power tool is maintained.

- › **Never service damaged battery packs.**

Service of battery packs should only be performed by the manufacturer or authorized service providers.

SAFETY WARNINGS COMMON FOR SANDING

This power tool is intended to function as a sander. Read all safety warnings, instructions, illustrations and specifications provided with this power tool. Failure to follow all instructions may result in electric shock, fire and/or serious injury.

Operations such as grinding, wire brushing or cutting-off are not recommended to be performed with this power tool. Operations for which the power tool was not designed may create a hazard and cause personal injury.

- Proper safety gloves are also recommended.
- Use the tool for dry sanding only.
- Use clamps or a vice to secure your work whenever possible.
- Use perforated hook-and-loop sandpaper with the prescribed dimensions.
- A sanding sheet that has been used for metal should not be used on other materials.
- Do not run the machine with any part of the casing missing or damaged.
- Never switch on the sander under load and place it down only after the head has come to a complete stop.
- Vibrations can injure the nerves in hands & arms. Keep exposure to vibrations as short as possible.
- When carrying out work, always ensure that you have a stable standing position.
- **Wear ear protectors.** Exposure to noise can cause hearing loss.
- **Wear eye protection.** Wear goggles to prevent eyes from exposure to flying particles.

- **Wear suitable gloves to protect hands.** Use of the power tool may expose the operator's hands to hazards including cuts, abrasions and heat
- **Wear a dust mask.** Take protective measures against inhalation of dust. Some materials can contain toxic materials. Also work with dust/ chip extraction when connectable.

Additional Safety Rules For Orbital Sanders

- **Hold the power tool by insulated gripping surfaces, when performing an operation where the cutting accessory may contact hidden wiring.** Cutting accessory contacting a "live" wire may make exposed metal parts of the power tool "live" and could give the operator an electric shock.
- **Do not use accessories which are not specifically designed and recommended by the tool manufacturer.** Just because the accessory can be attached to your power tool, it does not assure safe operation.
- **The rated speed of the accessory must be at least equal to the maximum speed marked on the power tool.** Accessories running faster than their rated speed can break and fly apart.
- **The outside diameter and the thickness of your accessory must be within the capacity rating of your power tool.** Incorrectly sized accessories cannot be adequately guarded or controlled.



- > **Do not use a damaged accessory.** Before each use inspect the accessory such as abrasive wheels for chips and cracks, backing pad for cracks, tear or excess wear, wire brush for loose or cracked wires. If the power tool or accessory is dropped, inspect for damage or install an undamaged accessory.
- > **After inspecting and installing an accessory, position yourself and bystanders away from the plane of the rotating accessory and run the power tool at maximum no-load speed for one minute.** Damaged accessories will normally break apart during this test time.
- > **Maintain a firm grip on the power tool and position your body and arm to resist kickback forces. Never place your hand near the rotating accessory.** Accessory may kickback over your hand.
- > **Do not position your body in the area where power tool will move if kickback occurs.** Kickback will propel the tool in direction opposite to the wheel's movement at the point of snagging.
- > **Use special care when working corners, sharp edges etc. Avoid bouncing and snagging the accessory.** Corners, sharp edges or bouncing have a tendency to snag the rotating accessory and cause loss of control or kickback.

Kickback and Related Warnings

- > Kickback is a sudden reaction to a pinched or snagged rotating wheel, backing pad, brush or any other accessory. Pinching or snagging causes rapid stalling of the rotating accessory which in turn causes the uncontrolled power tool to be forced in the opposite direction of the accessory's rotation at the point of the binding.
- > For example, if an abrasive wheel is snagged or pinched by the workpiece, the edge of the wheel that is entering into the pinch point can dig into the surface of the material, causing the wheel to climb or kick out. The wheel may either jump toward or away from the operator, depending on direction of the wheel's movement at the point of pinching. Abrasive wheels may also break under these conditions.
- > Kickback is the result of power tool misuse and/or incorrect operating procedures or conditions and can be avoided by taking proper precautions as given below.



CHARGER SAFETY

WARNING!

Read all safety warnings, instructions and specifications provided with the charger. Failure to follow all instructions listed below may result in electric shock, fire and/or serious injury. **Save all warnings and instructions for future reference.**

- **To reduce risk of injury, only charge JCB rechargeable batteries.** The charger and battery packs are specifically designed to work together. Other types of batteries may burst causing fire and personal injury.
- **Do not allow any liquid to get inside the charger.** Electric shock may result.
- **Do not expose the charger to rain or snow.**
- **Under certain conditions with the charger plugged into the power supply, the exposed charging contacts inside the charger can be shorted by foreign materials.** Foreign materials of a conductive nature such as, but not limited to, steel, wool, aluminium foil or any buildup of metallic particles should be kept away from charger cavities.
- **Always unplug the charger from the power supply when there is no battery in the cavity.**
- **Unplug the charger from the power supply before attempting to clean.**
- **Do not operate the charger with a damaged cord or plug.** Have them replaced immediately.
- **JCB chargers are designed to operate on standard household supply voltages. Check the rating plate of the charger matches your local supply voltage. (Note: the dual charger can additionally operate on worldwide 100-240V AC 50-60Hz input voltage). Do not attempt to use the chargers on any other supply voltage.**
- **This appliance can be used by children aged from 8 years and above and persons with reduced physical, sensory or mental capabilities or lack of experience and knowledge if they have been given supervision or instruction concerning use of the appliance in a safe way and understand the hazards involved.**
Children shall not play with the appliance. Cleaning and user maintenance shall not be performed by children without supervision.
- **If the supply cord is damaged, it can only be replaced by the manufacturer or an authorised service agent to avoid a potential hazard.**



COMPONENT LIST

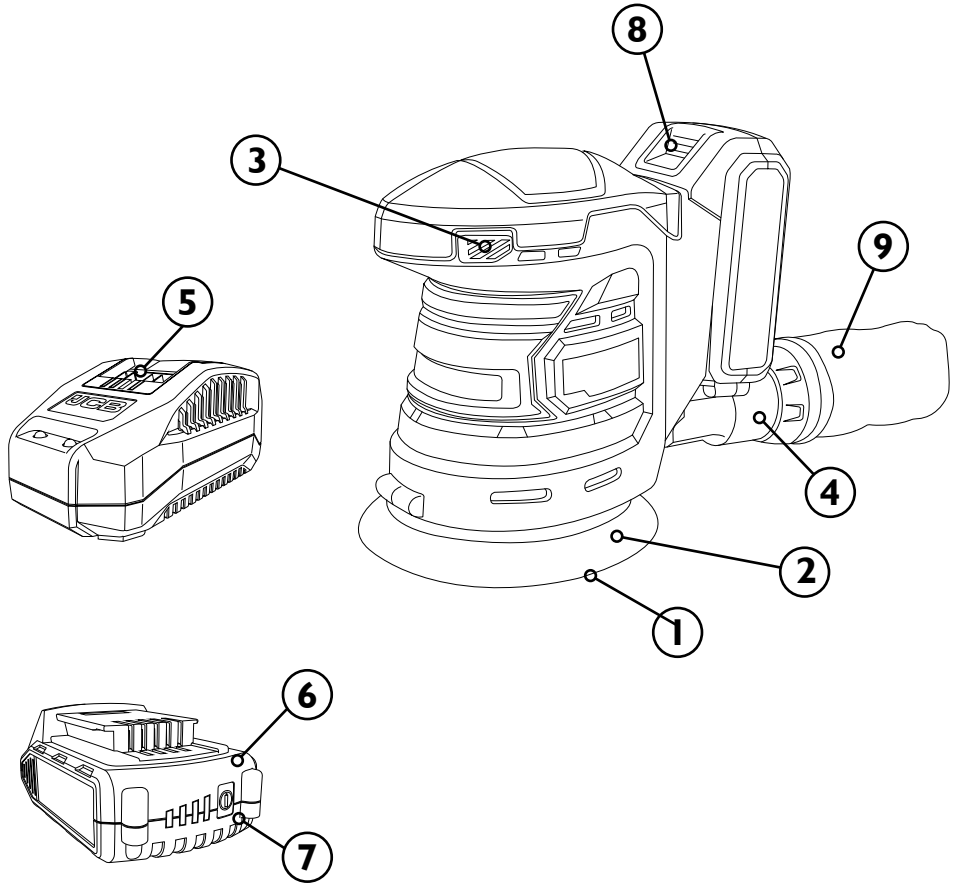

Battery size shown for illustrative purposes only

- | | |
|---|--|
| <ol style="list-style-type: none"> 1. ABRASIVE SHEET (SANDPAPER) 2. SANDING DISC 3. ON/ OFF SWITCH 4. DUST EXTRACTOR PIPE 5. CHARGER* - refer to page 11 for further information | <ol style="list-style-type: none"> 6. BATTERY PACK* - refer to page 11 for further information. 7. BATTERY TEST BUTTON AND CHARGE INDICATOR* 8. BATTERY RELEASE BUTTON 9. DUST COLLECTOR BAG |
|---|--|

*If applicable



TECHNICAL DATA

Input Voltage	18V dc (from attached battery)
Speed	0-10000/min
Sanding Disc Diameter	125mm
Pad Fixing Type	Hook and Loop Fastening System
Motor Type	Brushed
Motor Protection	Automatic over-current cut-off
Product Weight (body only)	0.98kg

LITHIUM ION BATTERY TECHNICAL DATA

Battery Code	Battery Size	Number of cells	Voltage	Battery Capacity	Charge Time (Fast Charger)	Charge Time (Super Fast Charger)	Charge Time (Dual Charger)
21-20LI	Small	5	18V	2.0Ah	45 mins	30 mins	35 mins
21-30LI	Large	10	18V	3.0Ah	65 mins	40 mins	45 mins
21-40LI	Large	10	18V	4.0Ah	90 mins	55 mins	60 mins
21-50LI	Large	10	18V	5.0Ah	110 mins	65 mins	75 mins
Charger Fuse Rating:					T2.4A	T3.15A	T5A
Times given as a guide only. Battery charge and discharge times dependant on age, usage and condition.							

CHARGER TECHNICAL DATA

Charger Code	Input Data	Output Data
JCB-18VFC	AC 220-240V, 50-60Hz, 70W	14.4 -18V d.c. 2.4A
JCB-18VSFC	AC 220-240V, 50-60Hz, 105W	14.4 -18V d.c. 4.0A
JCB-18VDC	AC 100-240V, 50-60Hz, 200W	20.5V d.c. 2 x 3.5A



NOISE INFORMATION

Total noise values determined according to EN 62841-2-4.

A-Weighted Sound Pressure (L_{pA})	76 dB(A)
A-Weighted Sound Power (L_{wA})	87 dB(A)
K_{pA} & K_{wA}	3 dB(A)

Wear ear protection when sound pressure is over 80 dB(A)

WARNING!

Wear hearing protection.
 The effects of noise can cause a loss of hearing. The above-mentioned noise emission values were measured in accordance with a standardised test procedure and can be used to compare one power tool with another.
 The above-mentioned noise emission values can also be used for the preliminary assessment of exposure.

WARNING!

The noise emissions during the actual use of the power tool may differ from the above-mentioned values depending on the power tool being used, in particular on the type of workpiece being processed.
 Try to keep emissions as low as possible, for example by limiting your working time. In this regard, all the operational cycle phases must be taken into consideration (such as the times when the tool is switched off or running idle).



VIBRATION INFORMATION

Vibration total values (triax vector sum) determined according to EN 62841-1 and EN 62841-2-4

Sanding	Vibration Emission Value ($a_{h,DS}$)	9.5 m/s ²
Uncertainty (K)		1.5 m/s ²

WARNING!

The vibration emission value of the power tool is tested under EN 62841-1 and EN 62841-2-4, and can vary during operation depending on the following usage conditions:

- How the power tool is used and the materials being cut, sanded or drilled.
- The power tool being in good condition and well maintained.
- Using the correct accessory for the power tool and ensuring it is sharp and in good condition.
- The tightness of the grip on the handles and if any anti-vibration accessories are used.
- The power tool being used as intended by its design and these instructions.
- The declared vibration total value may also be used in a preliminary assessment of exposure.

THIS POWER TOOL MAY CAUSE HAND-ARM VIBRATION SYNDROME (HAVS) IF USAGE IS NOT ADEQUATELY MANAGED.

WARNING!

To be accurate, an estimation of exposure level in the actual conditions of use should also take account of all parts of the operating cycle. These include times when the power tool is switched off and when it is running idle but not actually doing work. This may significantly reduce the total exposure level over the working period, helping to minimize your vibration exposure risk.

- ALWAYS use sharp and undamaged accessories, bits, chisels, drills and blades.
- Maintain this power tool in accordance with these instructions and keep well lubricated (where appropriate).
- If the power tool is to be used regularly then invest in anti-vibration accessories.
- Avoid using power tool in temperatures of 10°C or less.
- Plan your work schedule to spread any high vibration power tool use across a number of days.



OPERATING INSTRUCTIONS

Intended Use

This orbital sander is intended for dry sanding of wood, plastic, metal and filler material as well as painted surfaces.

The power tool must not be modified or used for any other purposes than the ones described in these instructions.

WARNING!

Before using the power tool on metal surfaces, always remove the dust bag from the outlet. Sparks may ignite the dust or the bag.

WARNING!

Prior to any assembly, adjustment or cleaning operations, always disconnect the power tool either from the power supply or remove the battery as appropriate.

ON/OFF Switch (3)

- On: Shift the ON/OFF switch slider to “I” position.
- Off: Shift the ON/OFF switch slider to “O” position.

Changing a Sanding Sheet

The sanding sheet (1) and sanding pad (2) are provided with a hook and loop attachment system to allow quick and easy changing of sanding and polishing sheets.

NOTE

Ensure the hook and loop surfaces of the sanding pad tool plate, and chosen sheet are as clean as possible, and free from any large debris prior to mounting the sheet.

To attach a new sheet:

- Align the edge of the disc with the edge of the pad, and ensure the sheet is centered in the plate.
- Apply pressure to the disc, ensuring it is securely fixed across the entire sanding pad.

To remove a disc:

- Lift one corner of the sheet and pull off from the sanding pad tool plate.

Dust Suction

- Efficiency and durability of sandpaper are much improved by dust suction through the apertures in the disc and sandpaper.
- The dust collector bag (9) is a push fit onto the dust extractor pipe (4).
- Dust collector bag must be emptied regularly.
- Ensure waste from the dust bag is disposed of as per local regulatory guidelines.

Dust Extractor Pipe (4)

- For sanding jobs that generate increased levels of dust, use a vacuum cleaner.
- Disconnect the dust collector bag and connect a pipe from your vacuum cleaner instead.

Sanding Surfaces

- Place the machine flat on the workpiece, ensuring the entire sanding disc makes even contact.
- Power on the sander.
- Apply uniform sanding pressure.
- Adjust your pressure to suit the work as required.

NOTE

Less sanding pressure increases the sanding capacity and protects the machine and the sanding paper.

NOTE

The removal capacity and the sanding pattern are determined mainly by the selection of the Sand paper (grade), the speed of the sanding pad and the application pressure.

Rough Sanding

- Attach a sand paper with coarse grain.
- Apply only light sanding pressure to achieve increased material removal.

NOTE

For faster material removal, do not increase pressure on the tool, instead use a coarser sanding sheet.

Fine Sanding

- Attach a sand paper with fine grain.
- With moderate pressure, move the machine in a circular pattern or alternately in lengthwise and crosswise directions over the workpiece.

NOTE

Do not tilt the machine during operation. This will apply uneven pressure, and may cause damage to the work piece (e.g. when sanding veneer).

NOTE

To avoid marring the finished surface, switch off the machine, and only lift it from the workpiece when it has come to a stop.

Orbital Sanding

- Guide your sander parallel to the working surface and move it in circles or in a cross pattern.
- The speed of the orbital motion of the sanding pad is reduced as applied pressure increases.

Selecting The Right Grade Of Sandpaper

- Use coarse grits to sand down rough finishes, medium grit to smooth the work and fine grit to finish off.
- The higher the grade number, the finer the grit.
- For rough work start with a low grade of grit. (e.g. 60 grit) and change to a higher, finer grade (e.g. 120 grit) for finishing.
- If you use a fine grade for rough surfaces the sandpaper will clog and need changing more frequently.

NOTE

The correct grade for your application will depend on sanding speed, material and pressure applied. Always test on a scrap piece of material if possible.



BATTERY AND CHARGER OPERATING INSTRUCTIONS

Battery

NOTE

Make sure the ON/OFF Switch slider (3) is not set to the ON position (I) when inserting or removing the battery. Use only JCB batteries: 21-20LI, 21-30-LI, 21-40LI and 21-50LI

- > **Do not use excessive force when inserting the JCB battery in the power tool.** An incorrectly connected battery can damage the battery terminals or the battery socket on the power tool.
- > Use the button (7) on the battery to check the charging status; 4 red LEDs indicates fully charged, where 1 indicates low battery charge status.

Charging The Battery

WARNING!

After charging for the first time, ensure the battery is completely discharged before placing on charge again. Repeat this charging and discharging cycle 4 to 5 times to ensure battery is correctly conditioned.

- > Place the battery charger on a level and stable surface. Plug the charger into a suitable power point.
- > Connect the battery pack to the charger so that it clicks into place.
- > Refer to the Battery Charge Level table below for battery charger status as indicated by LED lights.

- > When the battery pack is fully charged, unplug the battery charger from the power supply and remove the battery pack from the charger.

Battery Charge Level

Red LED	Green LED	Battery Charge Status
		Charger is connected to mains power
		Connected battery is charging
		Connected battery is fully charged
		Connected battery has a charging fault
		Charger is outside correct operating temperature range (<0°C / >40°C)

If the LEDs on the charger do not come on when charging:

- > Check that mains plug is properly connected to the power supply and the supply is switched on.
- > Check that the battery is correctly inserted in the charger.

Connecting the battery to the power tool

- > Connect the battery to the battery socket on the power tool so that it clicks into place.

Removing the battery from the power tool

- > Press the battery release button (8) and remove the battery from the power tool.

Overload protection

- When the power tool is overloaded (abnormal high current), the integral electronic control system will automatically protect the motor by switching off the power supply.
- Set the ON/OFF Switch slider to the OFF (O) position and wait one or two seconds for the electronics to reset, then restart the power tool.

WARNING!

Do not hold the work piece with your hands.

MAINTENANCE

Cleaning

WARNING!

Switch off the power tool and disconnect the power (remove battery/unplug) before cleaning and maintenance. This helps avoid the risk of electric shocks and accidental starting.

- Wipe the power tool with a dry or damp cloth. **Do not use a wet cloth. Do not use detergent that contains solvent or corrosive, abrasive additives.** This risks damaging the surfaces of the power tool.
- Clear the power tool vents and the blade clamp assembly of dust and dirt after each use. **Do not clean ventilation holes by inserting sharp objects in them, such as screwdrivers and other similar objects.**

- Stubborn contamination in areas hard to access can be removed with compressed air (max 3. bar).
- Regularly check all fasteners, screws and bolts to make sure that they are tight. Tighten any loose screws immediately or serious injury could occur.

Brush inspection

- Brush inspection and replacement should only be performed by an authorised JCB service centre.

Power tool lubrication

- JCB power tools are properly lubricated in the factory and are ready for use.

Repairs and servicing

- Power tools should be subject to periodic preventative maintenance to ensure continued safe and reliable operation.
- If the power tool requires servicing or repair (eg loss of power) do not continue to operate the power tool.
- Please return the power tool to an authorized JCB service agent or repair centre for service and repair using factory supplied identical replacement parts.

WARNING!

Never open the power tool. The power tool has no internal parts that the user can service or repair. Never try to repair the power tool yourself. Take to an authorised service centre.

Transport and Storage

- If the power tool will remain unused for any length of time, it should be stored in the original packaging.



- › Store the power tool in a dry, frost-free, well ventilated place with a temperature of no more than 40°C.
- › Keep all tools out of the reach of children.
- › Always switch off the power tool and disconnect it from the power supply (remove the battery/unplug the power cord) before transport.
- › Always carry the power tool using the purpose-designed handle.
- › Ensure that the power tool is not at risk of tipping over or exposed to excessive vibration and shocks during transport, especially if the tool will be transported by car or other vehicle.





WARRANTY STATEMENT

JCB Power Tools are guaranteed against manufacturing defects for up to 3 years from date of purchase by simply registering your product online within 30 days. Proof of purchase required. This does not affect your statutory rights.

To register your JCB Power Tool, please visit: jcb-tools.com

Online registration is required within 30 days to receive a warranty certificate to activate your standard 3 year warranty. Registration is only available online via www.jcb-tools.com. You will need your original sales receipt, the model number and the serial number (if applicable) of your product. Kits comprising of two or more tools are excluded from single registration and must be registered individually for full warranty cover.

Upon successful registration, a warranty certificate will be available to download, print or save as a PDF document. The relevant warranty certificate together with the original sales receipt will be required in the event of any claim within the warranty period.

Should you choose not to register your product within 30 days of purchase, your statutory consumer rights will not be affected. You will need the original sales receipt as proof of purchase in the event of a warranty claim.

Warranty cover commences from the date of purchase on the retail sales receipt and is valid only for JCB Tools products purchased within the UK bearing the CE and UKCA mark and a visible serial number.

In the unlikely event your JCB Power Tool is subject to a manufacturing fault within the warranty period, JCB Tools may repair the product by replacing defective parts free of charge at our discretion. In the event parts are irreplaceable JCB Tools may replace your product free of charge. The original product will remain the property of JCB Tools in this situation.

The above repair or replacement of products will be undertaken providing that:

- The product has been subject to fair wear and tear only.
- The product has not been subject to accidental or cosmetic damage.

- › The product has not been misused and has been used only in accordance with the instruction manual provided.
- › The product has not been subject to overload or insufficient servicing and maintenance.
- › The product has not been subject to any abnormal environmental conditions or inappropriate operating conditions.
- › Repairs have not been attempted by an unauthorised person and no modifications have been made to the product.
- › Repairs have not been undertaken using non-genuine spare parts.

JCB Power Tools used for Hire Fleets or as part of B2B and Service Contracts are not covered by these terms and conditions.

JCB Tools 3 Year Warranty excludes the following (where applicable):

- › Components normally subject to wear such as carbon brushes.
- › Batteries, Chucks and Chargers.
- › Accessories and consumable items.
- › Cases and tool storage products.

If your product develops a fault within 30 days of purchase, return it to the retailer where it was purchased together with your sales receipt. If a product develops a fault after 30 days a warranty claim must be submitted.

If you have a warranty claim please take your product, original sales receipt and if applicable, a copy of your extended warranty certificate to your place of purchase or nearest JCB Tools retailer.

If you wish to send your product to us directly, please send to JCB Tools, Unit 55, Romsey Industrial Estate, Greatbridge Road, Romsey, Hampshire, SO51 0HR, along with your original receipt and, if applicable, a copy of your extended warranty certificate. Delivery and repair charges may apply at our discretion should the warranty claim be invalid for any of the reasons illustrated above. In the event charges are not accepted the product will be retained by JCB Tools and remain the property of JCB Tools.

The information on both your sales receipt and your extended warranty certificate must match.

JCB TOOLS WILL NOT BE LIABLE FOR ANY INJURIES OR CONSEQUENTIAL DAMAGES RESULTING FROM USE OF THIS PRODUCT.



EU DECLARATION OF CONFORMITY				UK DECLARATION OF CONFORMITY
1.	PRODUCT(S) COVERED BY THIS DECLARATION:	Product: UK Product Code No. EU Product Code No. Factory Reference No.	JCB 18V Cordless Orbital Sander JCB-180S-B, 21-180S-B JCB-180S-B-E PLCSL-718	Batch Number: P.O.
2.	IDENTIFICATION DETAILS OF MANUFACTURER:	Name: Address: Country:	Yellow and Black Tools Ltd. (T/A: JCB Tools) Unit 55 Romsey Industrial Estate, Greatbridge Road Romsey, Hampshire SO51 0HR UK	
	AUTHORISED REPRESENTATIVE:	Name: Address: Country:	Authorised Representative Service 77 Camden Street Lower Dublin D02 XE80 Ireland	
3. THIS DECLARATION OF CONFORMITY IS ISSUED UNDER THE SOLE RESPONSIBILITY OF THE MANUFACTURER				
4.	OBJECT OF THE DECLARATION:	Product: Function:	18V Cordless Orbital Sander Dry Sanding	
5i.	THE OBJECT OF THE DECLARATION DESCRIBED IN POINT 4 IS IN CONFORMITY WITH THE RELEVANT UNION HARMONISATION LEGISLATION:	2006/42/EC	The Machinery Directive	
		2014/30/EU	The Electromagnetic Compatibility Directive	
		2011/65/EU	The Restriction of Hazardous Substances Directive	
5ii.	THE OBJECT OF THE DECLARATION DESCRIBED IN POINT 4 IS IN CONFORMITY WITH THE RELEVANT UK STATUTORY INSTRUMENTS:	2008 No. 1597	The Supply of Machinery (Safety) Regulations 2008	
		2016 No. 1091	The Electromagnetic Compatibility Regulations 2016	
		2012 No. 3032	The Restriction of the Use of Certain Hazardous Substances in Electrical and Electronic Equipment Regulations 2012	
6.	REFERENCES TO THE RELEVANT HARMONISED SAFETY STANDARDS USED OR REFERENCES TO THE OTHER TECHNICAL SPECIFICATIONS IN RELATION TO WHICH CONFORMITY IS DECLARED:	EN 62841-1:2015 EN 62841-2-4:2014 EN 55014-1:2017 EN 55014-2:2015	Electric motor-operated hand-held tools, transportable tools and lawn and garden machinery. Safety. General requirements Electric motor-operated hand-held tools, transportable tools and lawn and garden machinery. Safety. Particular requirements for hand-held sanders and polishers other than disc type. Electromagnetic compatibility. Requirements for household appliances, electric tools and similar apparatus. Emission Electromagnetic compatibility. Requirements for household appliances, electric tools and similar apparatus. Immunity.	
7.	ADDITIONAL INFORMATION. THE TECHNICAL DOCUMENTATION FOR THE MACHINERY IS AVAILABLE FROM:	Name: Address: Country:	Authorised Representative Service 77 Camden Street Lower Dublin D02 XE80 Ireland	
SIGNED FOR AND ON BEHALF OF: PLACE OF ISSUE: DATE OF ISSUE (DD/MM/YYYY): NAME: FUNCTION: SIGNATURE:		YELLOW AND BLACK TOOLS LTD. ROMSEY, UK. 07/06/2021 TIM BURGOYNE QA MANAGER 		